

Rectangular Wall Plates

Used to identify and trim flush mounted fire department connections.

Available in 2-, 3-, 4-, and 6-Hole, as well as horizontal, vertical, and square configurations.

* ESCH-2H also available with 7-5/8" center-to-center dimension.



ESCH-4H-PBSA

Part #	Configuration	# of Holes	A	B	C
ESCH-2H	Horizontal	2	15"	9"	7"
ESCH-3H	Horizontal	3	19.875"	9"	7"
ESCH-4H	Horizontal	4	30"	9"	7"
ESCH-6H	Horizontal	6	44"	9"	7"
ESCH-2V	Vertical	2	9"	15"	7"
ESCH-3V	Vertical	3	9"	19.875"	7"
ESCH-4V	Vertical	4	9"	30"	7"
ESCH-6V	Vertical	6	9"	44"	7"
ESCH-4S	Square	4	16"	16"	7"

Specify Finish:

- PB Polished Brass
- PC Polished Chrome

Specify Lettering:

- A Auto Spkr
- S Standpipe
- SA Standpipe & Auto Spkr
- DS Dry Standpipe
- WH Wall Hydrant
- PT Fire Pump Test
- BT Backflow Test

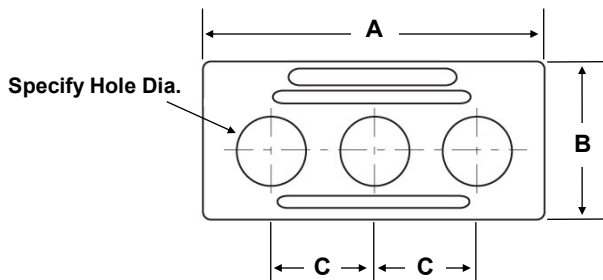

- 3" holes are designed for 2½" gate valves (#VAL53-25)
- 3½" holes are designed for 3" gate valves (#VAL53-3), 2½" female swivel snoots (#160), and 2½" males snoots (#163A25)
- 4-3/16" holes are designed for clappered snoots (#721) and 3" male snoots (#163A3)

Round Single Hole Wall Plates

Used to identify and trim exposed storz and fire department connections.

Standard Finish: Red Aluminum

Optional Finishes: Rough Brass, Polished Chrome

Thickness = 1/4"

590-4ALA



Part #	Size
24209-25	2½"
590-4	4"
590-6	6"
590-8	8"

Specify Finish:

- AL Red Aluminum
- RB Rough Brass
- PB Polished Brass
- PC Polished Chrome

- 2½" & 8" available in -RB and -PC only

Specify Lettering:

- A Auto Spkr
- S Standpipe
- SA Standpipe & Auto Spkr
- DS Dry Standpipe
- H Hydrant
- PT Fire Pump Test
- BT Backflow Test

- 8" available in -A, -S, -SA, and -PT only
- -BT available in 4" and 6" only

Step 1

Determine # of Holes in Wall Plate:

- 2 Holes
- 3 Holes
- 4 Holes
- 6 Holes

Step 2

Determine Wall Plate Hole Spacing:

- 7" center-to-center (standard)
- 7-5/8" center-to-center (available on 2-hole plates only)
- other (custom) _____

Step 3

Determine Wall Plate Hole Diameter:

- 3" - for use with 2½" F NPT permanent gate valves (#VAL53-25)
- 3½" - for use with 3" F NPT permanent gate valves (#VAL53-3), 2½" female swivel snoots (#160), and 2½" male snoots (#163A25)
- 4-1/8" (or 4-3/16") - for use with clappered snoots (#721) and 3" male snoots (#163A3)

Step 4

Determine Wall Plate Lettering:

- Auto Spkr
- Standpipe
- Standpipe & Auto Spkr
- Dry Standpipe
- Wall Hydrant
- Fire Pump Test
- Backflow Test

Step 5

Determine Mounting Orientation:

- Horizontal
- Vertical
- Square (4-hole only)

Step 6

Determine Finish:

- Rough Brass
(polished brass wall plate, all other visible components to be rough brass)
- Polished Brass
- Polished Chrome

Step 7

Determine Additional Components:

For Inlet-style FDCs

- **Swivel Snoots (#160)** - 2½" F NPT x 2½" F NST Swivel, for use on 2-way clappered bodies
- **Clappered Snoots (#721)** - 3" F NPT x 2½" F NST Swivel, for use on 3-way and larger clapperless bodies
- **Plugs & Chains (#311)** - w/ 2½" NST threads for use in snoots

For Outlet-style Test Headers

- **2½" Male Snoots (#163A25)** - 2½" F NPT x 2½" M NST, for use on 2-way bodies
- **3" Male Snoots (#163A3)** - 3" F NPT x 2½" M NST, for use on 3-way and larger bodies
- **2½" Gate Valves (#VAL53-25)** - 2½" F NPT x 2½" M NST, for permanent installation on 2-way test headers
- **3" Gate Valves (#VAL53-3)** - 3" F NPT x 2½" M NST, for permanent installation on 3-way and larger test headers
- **2½" Swiveling Gate Valve (#VAL078)** - 2½" F NST Swivel x 2½" M NST, for non-permanent installation. Designed to be used **WITH** our #163A25 or #163A3 male snoots
- **Caps & Chains (#31025)** - w/ 2½" NST threads for use on male snoots and valves