

Rectangular Wall Plates

Used to identify and trim flush mounted fire department connections.

Available in 2-, 3-, 4-, and 6-Hole, as well as horizontal, vertical, and square configurations.

* ESCH-2H also available with 7-5/8" center-to-center dimension.



ESCH-4H-PBSA

Part #	Configuration	# of Holes	A	B	C
ESCH-2H	Horizontal	2	15"	9"	7"
ESCH-3H	Horizontal	3	19.875"	9"	7"
ESCH-4H	Horizontal	4	30"	9"	7"
ESCH-6H	Horizontal	6	44"	9"	7"
ESCH-2V	Vertical	2	9"	15"	7"
ESCH-3V	Vertical	3	9"	19.875"	7"
ESCH-4V	Vertical	4	9"	30"	7"
ESCH-6V	Vertical	6	9"	44"	7"
ESCH-4S	Square	4	16"	16"	7"

Specify Finish:

- PB Polished Brass
- PC Polished Chrome

Specify Lettering:

- A Auto Spkr
- S Standpipe
- SA Standpipe & Auto Spkr
- DS Dry Standpipe
- WH Wall Hydrant
- PT Fire Pump Test

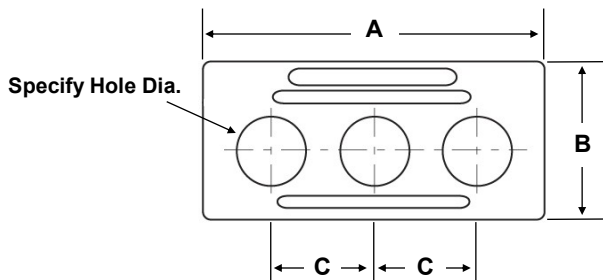

- 3" holes are designed for 2½" gate valves (#VAL53-25)
- 3½" holes are designed for 3" gate valves (#VAL53-3), 2½" female swivel snoots (#160), and 2½" males snoots (#163A25)
- 4-3/16" holes are designed for clappered snoots (#721) and 3" male snoots (#163A3)

Round Single Hole Wall Plates

Used to identify and trim exposed storz and fire department connections.

Standard Finish: Red Aluminum

Optional Finishes: Rough Brass, Polished Brass, Polished Chrome

Thickness = 1/4"

590-4ALA



Part #	Size
24209-25	2½"
590-4	4"
590-6	6"
590-8	8"

Specify Finish:

- AL Red Aluminum
- RB Rough Brass
- PB Polished Brass
- PC Polished Chrome

- 2½" & 8" available in -RB, -PB, and -PC only

Specify Lettering:

- A Auto Spkr
- S Standpipe
- SA Standpipe & Auto Spkr
- DS Dry Standpipe
- H Hydrant
- PT Fire Pump Test
- BT Backflow Test

- 8" available in -A, -S, -SA, and -PT only
- -BT available in 4" and 6" only